



Woodlands Court, Salters Lane, SO22 5FS

£1,550 PCM

** STUNNING LUXURY APARTMENT **

GD3 Property are delighted to offer this beautifully presented, executive apartment to let in Woodlands Court within the exclusive Holly Meadows development set within perfectly maintained gardens this second floor apartment has plenty to offer.

There is a lift in the block offering access to all floors, the apartment comes with allocated parking and has two balconies with views over the pristine gardens.

The apartment comprises of a large entrance hall which offers two fantastic storage cupboards. Off the hall is a large lounge which has double doors leading to balcony, a family bathroom containing three-piece white suite bathroom, double bedroom with built in wardrobes, modern fitted kitchen offering integral fridge/freezer, integral dishwasher, integral washer/ dryer and electric oven with 5 ring gas hob and extractor fan. The apartment offers a superb master suite which has a large double bedroom with balcony, walk in wardrobe which calls out to all fashion lovers and shopaholics and bathroom which features his and hers sinks and separate shower cubicle.

The property was redecorated throughout and new carpets were fitted after these photos were taken.

Ground Floor

Approx. 109.3 sq. metres (1176.9 sq. feet)

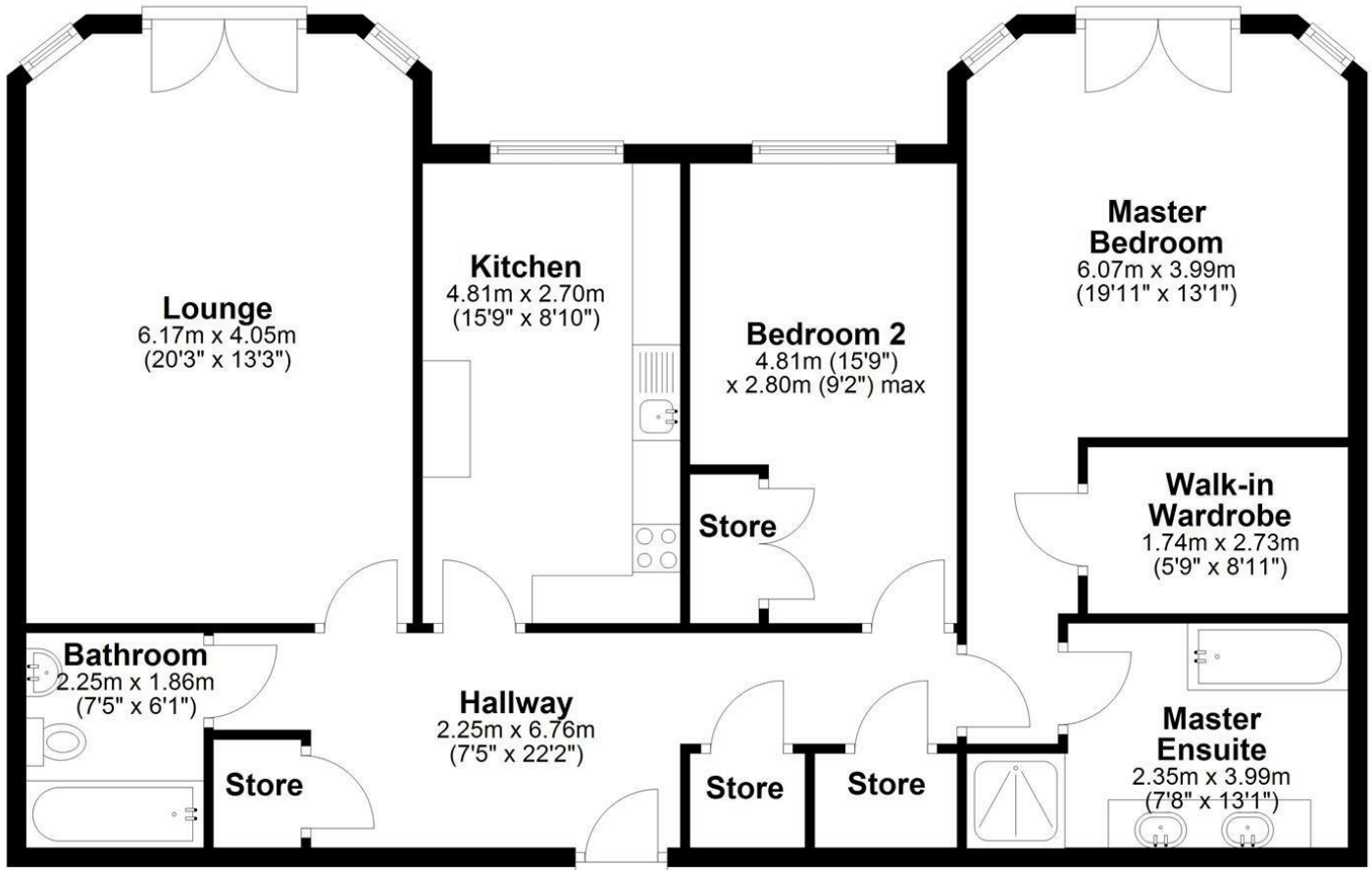

Total area: approx. 109.3 sq. metres (1176.9 sq. feet)

